

# PRODUCT DATA SHEET

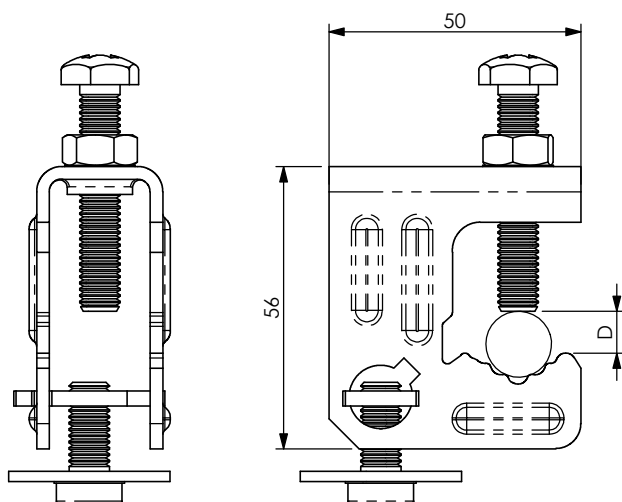

## A) SPECIFICATIONS

- 1 Stainless steel VEI 8x45 screw
- 2 Stainless steel bow MBM/8
- 3 Stainless steel elastic washer REI 8
- 4 Stainless steel exagonal nut DAI 8
- 5 Stainless steel washer RPI 8/32

## B) RESISTANCE TESTS

UV Test BS-ISO 105-B06  
Vibration test conforming to UNI 60068-2-6

## C) PACKAGING INFORMATION

Packing in boxes.  
Label indicating:  
product code, article, quantity,  
production batch,  
FIMO logo and figure.  
( Customer code on request ).

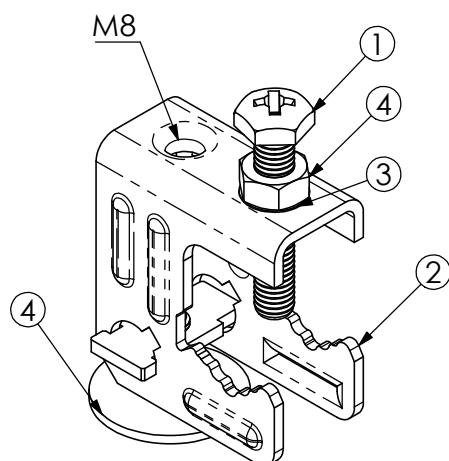

## D) MOUNTING INSTRUCTIONS

On request

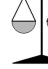

|         |                   |
|---------|-------------------|
| code    | <b>6115230125</b> |
| article | MBM/8             |

|   |   |
|---|---|
|  |  |
| 20  | 0.1549kg.   |

| RI  | DATE     | DR   | DATE     | AP  | Description:   |
|---|----------|------|----------|---|--|
| 02  |          |      |          |   | MBM/8=multidirectional clamp 8-25  |
| 01  |          |      |          |   |  |
| 00  | 16/09/15 | G.S. | 16/09/15 | A.V.  |  |
| 1 <sup>ST</sup> EMISSION  |          |      |          |   |  |
|  |          |      |          |  | Use: Multidirectional clamps, consisting of a stainless steel bow equipped with a M8 screw, allows hooking to various structures. By using M8 screw + a second hole inserted in a pivot pin other objects can be mounted and orientated. |