

# PPS 90

## Wall entry

- 1** Drill a hole  $\varnothing$  100 mm.

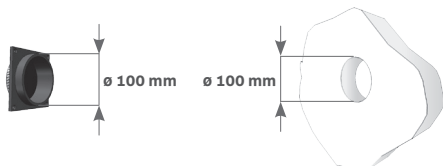

- 2** Drill holes for plugs ( $\varnothing$  8 mm).  
If necessary use the wall entry as template.

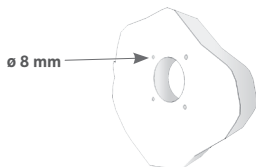

- 3** Insert plugs in the holes.  
Plugs are included in the package.

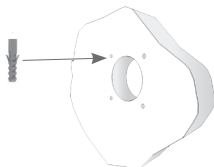

- 4** Insert the wall entry in the main hole.  
If necessary put silicone sealant between wall entry and wall.

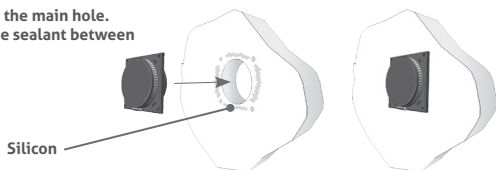

ST 014-6/11-A6-REV.0



All rights reserved.

Passing on and copying of this document,  
use and communication of its contents not  
permitted without Fi.Mo.Tec. S.p.A. prior consent.

## PPS 90

### Wall entry

- 5** Fix wall entry to the wall with screws.  
Screws are included in the package.

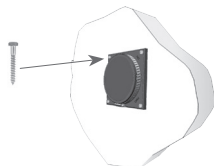

- 6** Remove sealing film of wall entry with knife and insert cables.

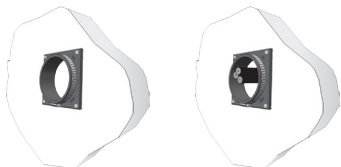

- 7** Apply LUS silicon grease to internal and external surfaces of cushions and cables. Insert cushions in hole.

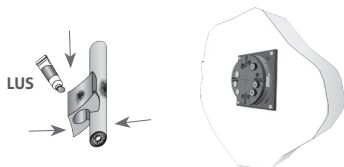

- 8** Put FAS steel hose clamp on rubber collar of wall entry. Tighten screw until closure is obtained.

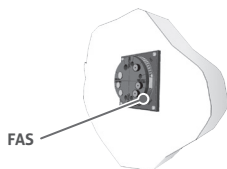

ST 014-6/11-A6-REV.0



All rights reserved.

Passing on and copying of this document,  
use and communication of its contents not  
permitted without Fi.Mo.Tec. S.p.A. prior consent.