

# SEC

## Saddles

Copyright © Fi.Mo.Tec. S.p.A.  
www.fimoworld.com

IST. 060 - REV. 0 - 03/17

### INSTALLATION INSTRUCTIONS

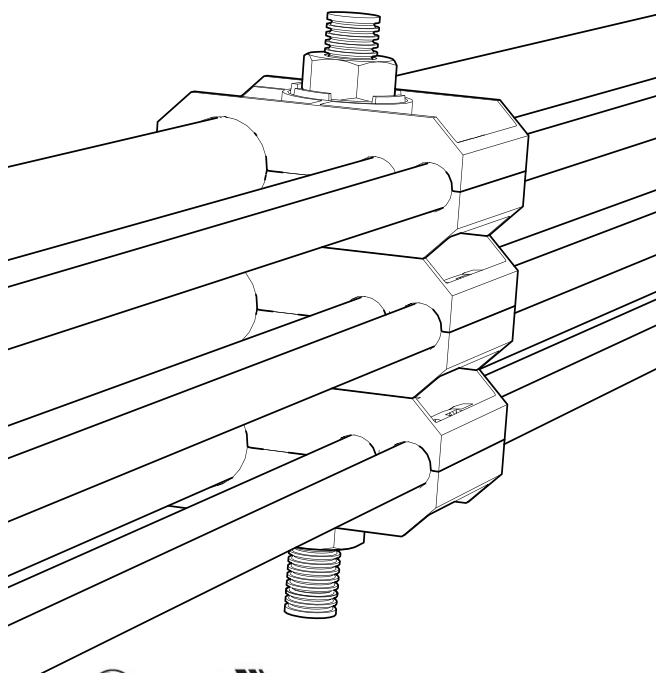

### ⚠ WARNINGS!

Installation of products must be performed by qualified, trained and experienced personnel. Installation personnel must be correctly and safely equipped. Mounting instructions and warnings must be read prior to installation. Warnings alert you to possible dangers about improper use of product. Failure to observe warnings may result in injury or death to you or others.



Fi.Mo.Tec. S.p.A.  
is certificated ISO 9001  
and RoHS DIRECTIVES  
compliant.



All rights reserved.  
Passing on and copying of  
this document, use and com-  
munication of its contents  
not permitted without Fi.Mo.  
Tec. S.p.A. prior consent.



### READ BEFORE INSTALLING

Insert cables with external diameter as per engraving  
on internal part of saddles.

SEC saddles are provided with flexible wings for the fixing  
of a wide range of diameters.

Never re-use SEC saddles with a larger cable compared to  
previous cable installed.

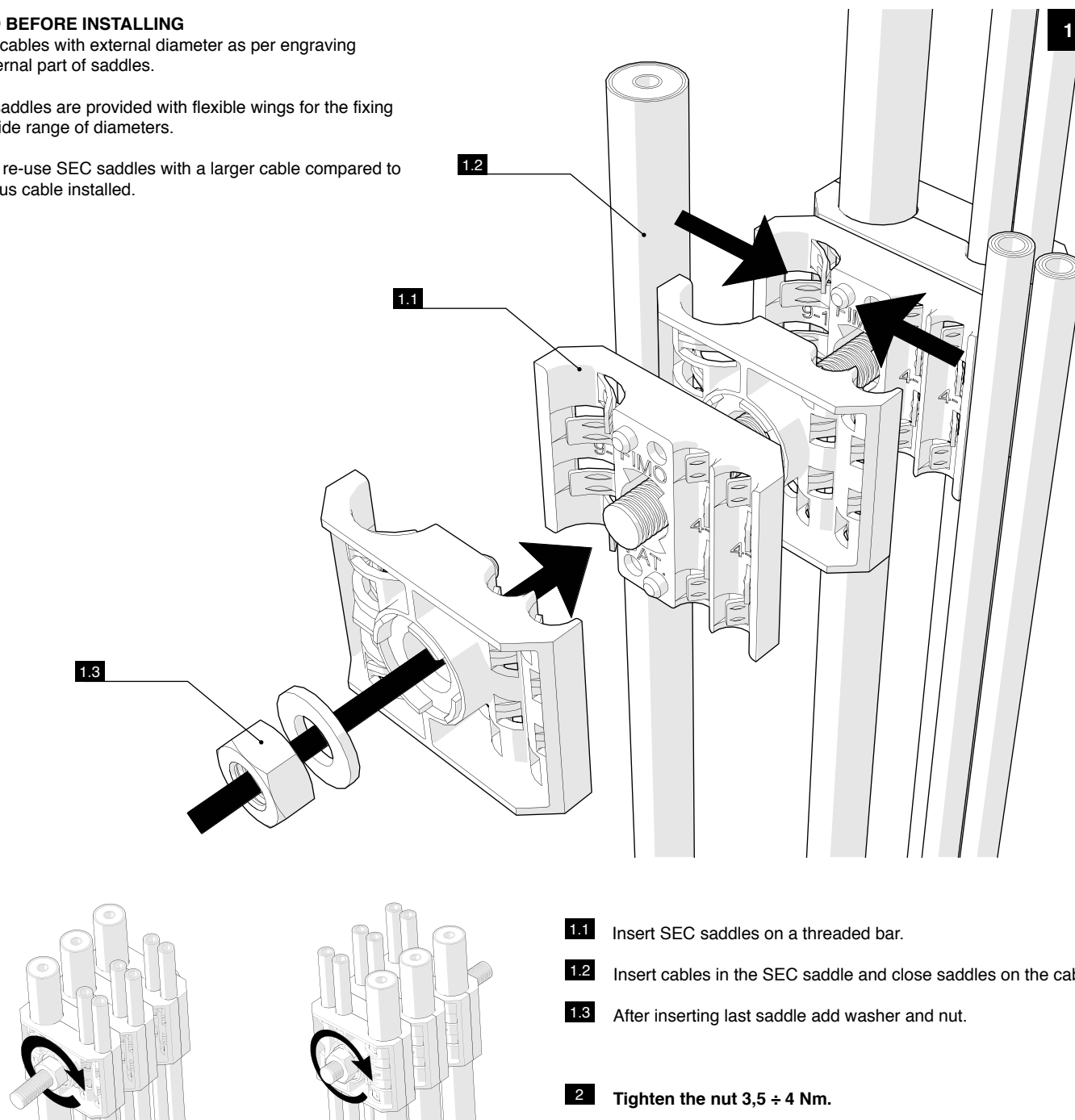

**1.1** Insert SEC saddles on a threaded bar.

**1.2** Insert cables in the SEC saddle and close saddles on the cable.

**1.3** After inserting last saddle add washer and nut.

**2** Tighten the nut  $3,5 \div 4$  Nm.