

PRODUCT DATA SHEET

A) SPECIFICATIONS

- 1 Stainless steel Socle
- 2 Stainless steel VCI 8x12 screw
- 3 Stainless steel REI 8 washer

B) PACKAGING INFORMATION



Packing in boxes.
Label indicating:
product code, article, quantity,
production batch,
FIMO logo and figure.
(Customer code on request).

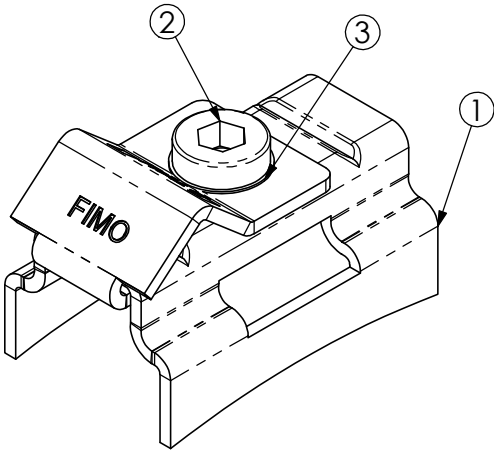
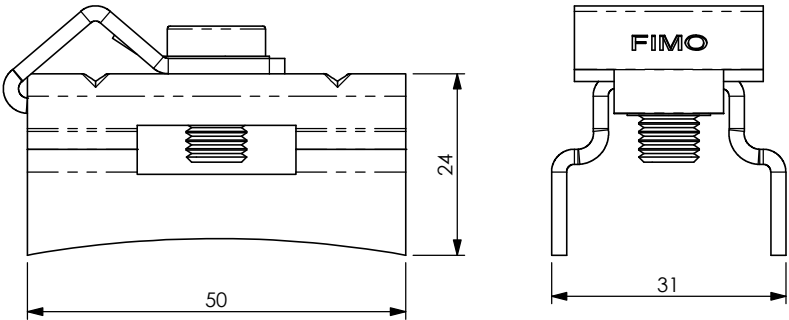

C) MOUNTING INSTRUCTIONS

On request

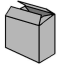

code	6118040812
article	BAC 8

	
20	0.0722kg

RI	DATE	DR	DATE	AP	Description: BAC 8=socle for steel strip 20 mm +CAB
02					
01					
00	28/01/2016	E.B.	28/01/2016	A.V.	
1 ST EMISSION					
 Building Sustainable Innovation					Use: <i>The socle can be applied through stainless steel strips BIT 19 or hose clamps FAS and FAU to various structures like poles and pylons. The bow with M8 screw allows Socle the fastening of brackets and threaded bars ø 8-12.</i>